



Mission Bay Development Group, LLC
401 Terry Francois Blvd.
San Francisco, CA 94158
Tel. (415) 355-6600
Fax. (415) 355-6670
April 14, 2025

INSTRUCTIONS TO BIDDERS

Mission Bay Development Pump Station 3 Bid Documents

BID ADDENDUM 2

Bid Date: 2:00 PM, April 17, 2025 April 23, 2025

Please note, any additions from Bid Documents dated March 7, 2025 are in bold face and deletions have been stricken through. The notes contained herewith are in addition to the previous Instruction to Bidders. Please consider other addenda as if they were attached herein their entirety.

- 1. Contractor Bid Scope Section 1.4:** All bids, including Bid Summary and Schedule of Values, must be submitted according to the instructions in the Instructions to Bidders no later than 2:00 PM on April 10th, 2025 April 23rd, 2025
- 2. Contractor Bid Scope Section 1.6:** All Bidders must be able to attend a post bid interview on ~~April 17th, 2025~~ **April 25, 2025** between the hours of 11:00 AM and 3:00 PM.
- 3. Instruction to Bidders has been revised as follows:**
 - a.** Bid Date: 2:00 PM, ~~April 10th~~ **April 23rd**, 2025
- 4. Instruction to Bidders item 2.1.29 has been revised as follows:**
 - a.** Attachment 29: ~~Executed Control Room Agreement (Pump Station No. 3 Control Room, Block 8711, Lot 14) & Recorded Memorandum of Control Room Agreement Executed Construction Coordination Agreement (Pump Station No. 3, Control Room and Transformer Room, Block 8771, Lot 14) & Executed License Agreement (Pump Station No. 3, Control Room and Transformer Room, Block 8771, Lot 14)~~

b. Replace Bid Attachments 29a and 29b with the attached replacement documents corresponding with the changes noted above.

5. An updated version of the project plan holders list is included in this addendum.

6. The contract Milestones have been modified as follows:

Contract Schedule Milestones

Please note the following significant milestones regarding our proposed schedule.

6.1 Notice to Proceed	May 19th 2025
6.2 Sluice Gate, CDS Unit, Wet Well Complete	October 1st 2026
6.3 Utility Work in the Street and Control Room Complete	February 1 st 2027
6.3 Substantial Completion	April 1 st 2027
6.4 Final Completion	April 19th 2027

General Contractor Request for Information (RFI) and Response:

Q29: Does the owner have access to any properties that can be rented for staging and parking?

A29: There are currently two locations available to rent for staging purposes, which are approximately 10,000-11,000 SF each. Both areas are located close to the intersection of Owens and Mission Bay Drive Circle, approximately 1/2 mile from the project site.

The cost for the available laydown areas is:

**Site A = \$7,500/month
Site B = \$12,500/month**

Q30: Section 01 15 00 Construction Site Security indicates video monitoring for projects identified by the designated City Representative. Please confirm if this project requires video monitoring.

A30: The project site is located at a major intersection in a public park. There will be significant foot and vehicular traffic immediately adjacent to the project, throughout construction. Site security including the protection of the public, is the contractor's responsibility. For the purposes of this bid, monitored security is suggested, but will not be required.

Q31: Will the large diameter RCP required to be double gasketed?

A31: No, Single gasketed pipe is all that is required.

Q32: Will testing, adjusting, and balancing (TAB) for HVAC shown on M3S-MV-1.1 be required? If yes, please provide spec section.

A32: Yes, Please reference Special Provision section 23000 & 23050.

Q33: Will a spec section Fire Dampers & Fire Smoke Dampers shown on M3S-MV-1.1 be provided?

A33: Yes, Please reference Special Provision section 23000 & 23050.

Q34: Will a spec section for the louvers shown on M3S-MV-1.1 be provided?

A34: Yes, Please reference Special Provision section 23000 & 23050.

Q35: Will a spec section for the smoke detectors on M3S-MV-1.1 be provided?

A35: Yes, Please reference Special Provision section 23000 & 23050.

Q36: Has there been coordination with PG&E in regard to the transformer installation in the transformer room?

A36: Yes, PG&E has been engaged and is aware of the project. The Contractor will be responsible for coordinating field meetings and/or inspections with PG&E as necessary to facilitate the work. Note that the PG&E conduits from the primary vault in the sidewalk on Channel St. to the stub-outs from the transformer room at the building foundation have not yet been installed.

Q37: Is there any design flow criteria or hydraulics information for the existing storm drain system that could be used for sizing of bypasses?

A37: Yes, Please see the attached Bid Addendum 2 sketch for the anticipated storm drain flow rates.

Q38: Attachment 1A item 2.57.5 states "shoring material shall be in new or "as new" condition. Please confirm if the shoring system utilized is to remain in place after construction is complete. If the shoring is to be removed, please confirm if the material used needs to be new.

A38: Per the Geotechnical recommendations, should the contractor's shoring system utilize sheet piles, the sheet piles should be left in place to avoid potential settlement of the pump station and existing infrastructure including the City's combined sewer box, MUNI rail lines, OCS poles, SFMTA and MUNI interconnects, and the 4th Street bridge.

Q39: Note #2 on sheet M3S-C-2.2 states the contractor is responsible for bypassing existing flows. Please confirm if a bypass plan will be provided prior to bid submission. If not, is a work sequence and/or flows going to be provided?

A39: A draft Utility Phasing Plan has been included in the bid documents (Attachment 34) to use as a guide for work sequencing. Please see the Bid Addendum 2 sketch for the anticipated storm drain flow rates. The contractor holds the responsibility to develop and

implement any required bypass plans, which shall be subject to review and approval by the PUC and Owner.

Q40: In accordance with the project scope all work to be performed in accordance with the Geotechnical Investigation. The report indicates leaving sheet piles in-place, but the shoring specification is less clear about this requirement. Please confirm if sheets are to be left in place for the new large structures: Pump Station and CDS.

A40: Per the Geotechnical recommendations, should the contractor's shoring system utilize sheet piles, the sheet piles should be left in place to avoid potential settlement of the pump station and existing infrastructure including the City's combined sewer box, MUNI rail lines, OCS poles, SFMTA and MUNI interconnects, and the 4th Street bridge.

Q41: The Geotechnical Investigation also discusses installing soil cement columns below the mat subgrade at the pump station to stabilize the subgrade. Will soil cement columns be required, or can we optionally stabilize the subgrade with a mud-slab?

A41: On recent pump station projects in Mission Bay, where young bay mud is present, the floor of the wet well excavation was stabilized through overexcavation and a section of stabilization fabric and drain rock. An unreinforced rat slab was then placed on top of the stabilization section which sealed the floor of the pump station as well as braced the shoring walls.

Q42: From the phasing plans it appears the intent is to bring the new pump station on-line before the existing pump station and associated 36" SD line are taken out of service. In the event the new pump station is not ready for service (electrical gear supply issues discussed below), can the bypass flows be provided for the 36" SD line?

A42: Yes, Please see the attached Bid Addendum 2 sketch for the anticipated storm drain flow rates.

Q43: Will the concrete fill at the pump station bottom require reinforcing steel, doweling, and roughening of the contact surface? If so, please provide additional detail information.

A43: The strength, depth and reinforcement requirement of the rat slab at the bottom of the shored excavation, shall be per the contractor's engineered shoring design. Dowels and a roughened surface are not required.

Q44: Pump Station details indicate exterior Water Proofing and Filter Boards on walls and footings. Please clarify if Water Proofing and/or Filter Boards will be required on the CDS Structure, Sluice Gate Structure, Flow Meter Vaults, or any other structures/MH/Vaults.

A44: Water Proofing will be required on the CDS Unit, Sluice Gate Structure and Diversion structure. Please reference Sheet M3S-C-25R.

Q45: Sheet 20, M3S-C-7R, indicates a new 10"SD line and new Catch Basin. As there are no bid items for this work, please confirm that this work is intended to be included in this work scope.

A45: The new 10" SD line shown on Drawing M3S-C-72 is to be included in the work scope. A profile of this line is currently being developed by the EOR and will be provided in a future Instructional Bulletin. Please include the cost for this work in SOV Item # 101.

Q46: Bid Scope 5.1 – Allowance 1 – Hazardous Soils Disposal Costs only. Is this the same as Allowance 1 and Alternate 01 in the Bid Proposal which includes Transportation and Disposal of Non-RCRA Hazardous Materials for a predetermined amount of \$400,000.00, and an Alternate unit price per Ton? If not, please provide additional information.

A46: Yes.

Q47: Bid Scope 5.2 – Allowance 2 – Permit Fees. Instructions to Bidders Item 9.19 details permitting and states Owner will reimburse the contractor for these permit fees. Please clarify the intent of this allowance. Note that this Allowance is not on the bid form.

A47: The allowance will be included in the contract. The intent of the allowance will be to reimburse the contractor at cost for any permit fees assessed by the city for the duration of the contract.

Q48: Bid Scope 5.3 – Allowance 3 – Contaminated Groundwater disposal costs. The site is described as CL-II Contaminated which requires treatment prior to discharge into the city sewer system. The bid scope item 2.49 states the Owner shall reimburse the contractor for the permit fee, but are we to assume this does not include the discharge fees associated with the permit? Also, note that this Allowance is not on the bid form.

A48: The contaminated groundwater allowance will be included in the contract. The contractor is responsible to remove the groundwater from the excavation and desilt the water in baffled tanks to remove sediment and to pay for any discharge fees of the clean water into the city sewer system. If the water is determined to be contaminated, any treatment after the contract desilting process required by the city prior to discharge into the city system shall be paid for out of the allowance.

Q49: The Draft Utility Phasing Plan included as Attachment 34 includes preliminary storm drain investigation work. Is this work required to be performed?

A49: Yes, please include the cost of the investigatory work scope indicated on Page 1 of the Utility Phasing Plan in Attachment 34 in the bid. This work should take place at the beginning of the project to verify current storm drain conditions and identify any discrepancies that may exist in advance of any bypass or storm drain modification/construction work. The cost for this work shall be included in SOV #1.

Q50: As mentioned at the pre-bid and since re-confirmed with electrical subcontractors, the anticipated lead times for the electrical gear is 50 weeks not including the submittal process, which can add many weeks if not months. A likely scenario would be receipt of electrical gear in September 2026 and approximately 6 months to complete the remaining Phase 3-5 work pipe installation/demo along with electrical, hardscape, flatwork, landscape, and pavement restoration. This is a rough estimate as actual

durations not yet analyzed. Given the final completion date of December 18, 2026 and high liquidated damages of \$5,000/day we would request an accommodation be provided for the electrical lead times.

A50: The Contract milestones have been revised as noted above.

Q51: There appears to be a discrepancy between the number of palm trees shown to be removed in the plans and what is included in the Bid SOVs. Please clarify.

A51: There are 2 additional trees shown to be removed in the Storm Water Pump Station No. 3 Phase 1 Demolition plan set, which is the reason for the quantity discrepancy in the SOVs. That said, based on field investigation, there do not appear to be any palm trees to be removed on the project. All Bids shall submit SOV # 8 as \$0.00. All bids shall assume that SOV #'s 9 & 10 shall be Lump Sum rather than priced per each. The trees shown to be removed vary in type and some of these are no longer present due to having fallen over during past storm events.

Q52: There appears to be a discrepancy between the number of Remote Control Valves shown to be installed in the plans and the number of callouts. There are 20 RCV symbols but only 18 callouts. Please clarify.

A52: Please redline the Bid SOV to include 20 RCVs.

Q53: Can the bid date be extended to 4/23/25?

A53: Bid date has been extended to 4/23/25 per this addendum.

Q54: What are the extents of structural soil tree planting trench? Detail 6/M3S-L5.02 shows width and depth however the length of trench required along Channel Street and 4th Street is not shown. Confirm width and length.

A54: The trees along Channel and 4th Street are connected by an existing continuous Structural Soil Tree Trench. The intent of the new design is to remove and replace any length of tree trench that is impacted by the installation of the improvements. The Structural Soil does not need to be restored where it conflicts with shallow pipes, at utility vaults or other improvements.

Q55: Are all planting areas, including turfgrass, to receive a 24" depth of conditioned soil?

A55: Please refer to Stormwater Pump Station 3 (M3S) Special Provisions Section 02910-3.1 for topsoil placement specifications – See Bid Attachment 6.

Q56: Detail 2/M3S-L5.02 calls for 24" of conditioned planting soil, detail 3/M3S-L5.02 calls for conditioned import planting soil. Is it acceptable to amend existing stockpiled soil or is import topsoil required?

A56: Please assume that all conditioned planting soil shown to be installed in the plans shall be imported.

Q57: Detail 1/M3S-L4.02 calls for one "Mega Stake" to be installed at each sidewalk tree while Details 5&6/M3S-L5.02 call for 2 Schedule 40 steel poles to be installed at both the street and park trees. Please advise which tree staking system is to be used.

A57: Detail 1/M3S-L4.02 will not be required on this project. Please assume detail 5&6/M3S-L5.02 which calls for 2 Schedule 40 steel poles will be required at each new tree.

Q58: Section 02921 - Soil Preparation, Part 3.2C - Topsoil Depth states "Minimum depth of (6 in.) (12 in.) after natural settlement and light rolling conforming to finished grades shown on Drawings." Also detail 2 & 3/M3S-L5.02 call for 24" depth of soil. Clarify topsoil depth.

A58: Please refer to Stormwater Pump Station 3 (M3S) Special Provisions Section 02910-3.1 for topsoil placement specifications – See Bid Attachment 6.

Q59: Detail 6/M3S-L5.02 shows continuous underdrain within the structural soil under the street tree planting. However, both the drainage and utility plans, M3S-C-3.0R and M3S-C-7R, don't show any drainage pipe to be installed. Please advise.

A59: Existing tree drain shall be maintained, intercepted and brought to the sluiceway junction structure when impacted by construction, per Sheet M3S-C-3.0R.

Q60: Detail 4/M3S-C-1.0 specifies Mission Bay Standard Removable Bollards to be installed and says to refer to specs for manufacturer's information. The specs don't provide any information on the bollards. Please provide manufacture and supplier's information for the bollards.

A60: The bollards shall be Urban Accessories DG-5, Removable Mount Bollards, in Cast Iron Grey.

Q61: Is the Contractor obligated to provide a price for the quantities of Work shown on the Plans, or the quantities of Work listed on the SOV?

A61: Contractor shall provide pricing based upon its takeoff of quantities of work shown on the plans. Contractor shall request clarifications on any SOV items that it believes require modification, prior to submittal of the bid, and these will be reviewed for merit and addressed via a subsequent addendum, if necessary.

Q62: Note that the 'Contract Bid Scope' article 2.9 states that the Contractor shall perform all work in accordance with the geotechnical investigation, and that all recommendations shall be considered requirements. See page 17 of the Geotech report, which makes 3 recommendations to mitigate settlement; Leave Sheet Piles in Place, Support Structure on Piles, and Install soil cement columns. It appears that none of these recommendations are incorporated into the final design. Please confirm this in general. Please confirm specifically that the sheets are not required to be left in place.

A62: The engineered shoring design is considered the contractor's ways and means. On recent pump station projects here in Mission Bay, several shoring systems have been used. Drilled in place secant walls and driving like new sheet pile systems have created water tight excavations and have been efficient ways to shore the wet well excavations. When well used sheetpiles with bent and unusable interlocks were installed, the shoring system was not watertight and the contractor fought the groundwater for the duration of the project at his significant expense.

Q63: Attachment 32 - SWPS3 Phase 1 DEMO SET COMPLETE - 10-30-09, shows utility capping, utility demolition, and partial demolition of the existing pump station. Attachment 34 - Utility Phasing Plan, represents 5 phases of for the utility work. However, it does not include or represent the work shown on Attachment 32. Please clarify when the work shown is supposed to occur relative to the 5 phases shown on Attachment 34.

A63: The draft Utility Phasing Plan included in attachment 34 is being provided solely as a guide for phasing and sequencing of the work. It is the Contractor's responsibility to determine the actual means and methods required to perform the work. The demolition work scope can occur at any time as long as temporary measures are put in place to maintain stormwater flows throughout the course of the work.

Q64: Please confirm if we can use PVC Schedule 40 fittings for spray heads and rotors, as shown in Detail 9 and 10 on Sheet M3S-LI-1.02.

A64: Please provide Sch 80 fittings.

Q65: Irrigation legend sheet on M3S-LI-1.00 indicates that the controller should be wall-mounted, while Detail 1 on Sheet M3S-LI-1.02 requires a pedestal, please clarify.

A65: The new controller shall be wall-mounted within the park pavilion building per Note 3 on M3S-LI-1.01. Please reference Attachment 24 & 25 for the existing irrigation plans in the park.

Q66: Please provide location of the existing backflow preventer that needs to be relocated, as indicated in the irrigation legend on Sheet M3S-LI-1.00.

A66: Location of backflow preventer to be relocated is shown on Drawing Nos. C-4 and C-5 of the Storm Water Pump Station No. 3 Phase 1 Demolition plan set. See Bid Attachment 32.

Q67: Please provide sleeve size for the lateral lines on Sheet M3S-LI-1.01.

A67: Please provide sleeves for any lateral lines per the callouts on Sheet M3S-LI-1.01. Any sleeves without a callout shall be 4".

Q68: Please provide size of remote-control valves served for shrub areas located in the center of Sheet M3S-LI-1.01.

A68: Please assume the RCVs shall be 1.5"

Q:69: Please provide size of remote-control valves located near RCV#16 and RCV#17.

A69: Please assume the RCVs shall be 1.5"

Q70: Please verify location of Controller B as indicated in the irrigation legend on Sheet M3S-LI-1.00.

A70: Controller to be located at Park Pavillion Building per Note 3 on Drawing No. M3S-LI-1.01.

Q:71: There is a gate valve symbol located on the existing mainline; however, it sits outside the limits of work. Please advise if this gate is excluded from our scope of work.

A71: Assuming the gate valve in question is the one that is shown just west of the service line connection from the new backflow preventer, there does not appear to be an existing gate valve at that location. Please include the price to furnish and install that gate valve in the bid.

Q:72: Sheet M3S-LI-1.01 calls out to remove symbols of the existing mainline and lateral line. However, sheet note 4 on the sheet states that all existing sprinkler heads, valves, and lateral lines must be removed. Please clarify the scope of this work.

A72: Assume complete removal of all mainline and lateral sections shown to be removed per note 4, including sprinkler heads, valves, and lateral lines being fed by those lines.

Q:73: Please clarify the scope of demolition work as outlined in Section 2.20 of Attachment 1a – SWPS #3 Contractor Bid Scope.

- 2.20 Perform all the demolition activities shown on the plans including but not limited to the abandonment/removal of existing utilities, structures, landscaping, lighting, signage, and hardscape. Contractor is responsible to develop and have approved by the City any bypass and phasing plans required to maintain flows through any lines impacted by the new work. The draft utility phasing plan included in the bid documents can be used as a guide but has not been approved by the City at the time of bid.

A73: Please refer to Drawing Nos. M3S-C-2.0, M3S-C-2.1, M3S-C-2.2, and Attachment 32 of the Bid Documents for demolition work scope.

Q:74: There is no bench symbol shown in the drawings, although it is mentioned in Section 2.37 of Attachment 1a – SWPS #3 Contractor Bid Scope. Please advise if this is excluded from our scope.

A74: There are no benches included in this project.

Q75: Please provide location of the existing cobblestone which is harvested and reinstalled at sidewalk tree wells receiving new trees. Additionally, if the existing cobblestones are insufficient, please provide the materials used for these cobbles.

A75: Contractor to salvage cobbles from existing tree wells to reuse at new tree well locations. If additional cobbles are required, they will be provided by owner.

Q76: According to Detail 6 on Sheet M3S-L5.02, there is a callout requiring a 4" diameter perforated pipe in drain rock. However, we cannot locate this on the drawings. Please provide their locations in the drawings.

A76: Existing tree drain shall be maintained, intercepted and brought to the sluiceway junction structure when impacted by construction, per Sheet M3S-C-3.0R.

Q77: Please confirm that maintenance period shall be 1 year for bidding purposes.

- C. Failure to provide the above submittals may result in the re-scheduling of the Progress Maintenance Observations and to extend the 1-year Maintenance Period.

A77: All bids shall include a 90 day Plant establishment period, as described in the Standard Specifications. There will be a 2 year warranty period on the new installation but a 1 year maintenance period for the landscape improvements will not be required.

Q:78: Please provide on center spacing for Carex pansa in Turf block.

	CAREX PANSA IN TURFBLOCK	SAND DUNE SEDGE	PLUG	GROWING UNDER 6" UNMOWED MAY REQUIRE CONTRACT GROWN
---	--------------------------	-----------------	------	---

A78: Each Turf block cell shall be filled with Carex Pansa plugs. The amount of plugs per cell shall not exceed the cell block manufacturer's installation recommendations.

Q:79: Please define for the vault covers to be used for utilities per scope note 2.38 as required by Landscape contractor

2.38 Contractor shall furnish and install architectural vault covers (AVC's) for utilities located in the street furnishing zone (sidewalks adjacent to 4th St. and Channel St.).

A79: Please refer to Bid Addendum 1, Item 4 and corresponding General Contractor Request for Information No. Q24.

Q:80: Refer to part 2.2 of section 02906, sod type is specified as Medallion Extreme purchased from Pacific Sod. However, this vendor is permanently closed. Could you recommend for any product as an alternate?

2.2 SOD

- A. Sod Type: Medallion Extreme, Pacific Sod, 1-800-692-8690.
- B. Sod shall be dark green in color, free of thatch, diseases, weeds and harmful insects.
- C. Sod shall be reasonably free of objectionable grassy and broadleaf weeds. Sod shall be considered weed free if no more than 10 percent of such weeds are found per 100 square feet.

A80: Contractor to submit an equal product from a preferred vendor for consideration.

Q:81: Planting detail sheet 5 shows to use galvanized tree stake, while specs provides tree lodge pole. Please clarify.

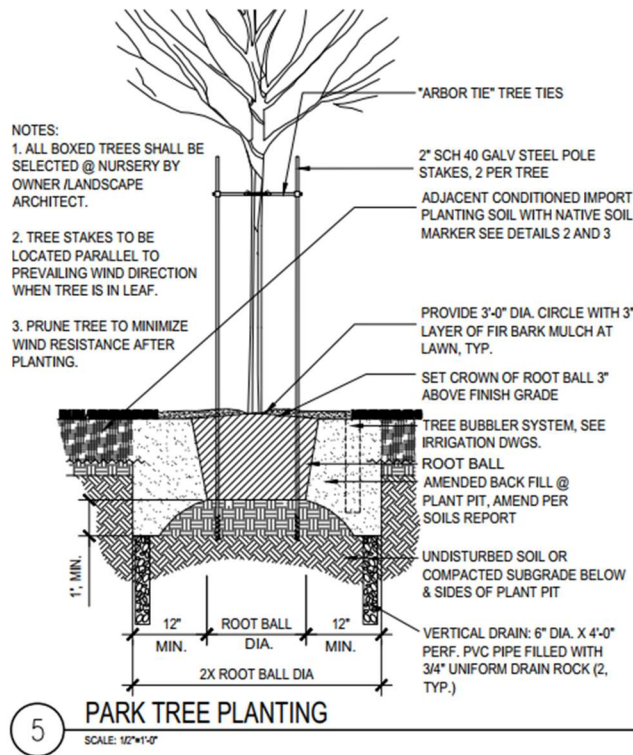

2.4 STAKING MATERIALS

- A. Trees to be staked using two (2) 2.24-inch o.d. treated lodge pole pine tree stakes as supplied by Ewing Irrigation, San Francisco, CA, Tel. (415) 695-9530, or accepted equal.
- B. Tie sleeves to be model 200 sleeves with stainless steel vandal resistant screws as supplied by Robert W. Poyas, Inc., San Francisco, CA, Tel. (415) 863-9880, or accepted equal.
- C. Tie straps to be WonderTie straps as supplied by Robert W. Poyas, Inc., or accepted equal.
- D. Cross brace: pressure treated Douglas Fir, size as shown on the Drawings. Fasten to poles with galvanized masonry nails.
- E. For "Street Tree Planting" follow materials to Mission Bay Standard as identified under specification 2950 and standard details.

A81: Detail 1/M3S-L4.02 will not be required on this project. Please assume detail 5&6/M3S-L5.02 which calls for 2 Schedule 40 steel poles will be required at each new tree.

Q:82: Refer to part 3.1E of section 02910, the depth of imported topsoil to place all shrub and ground cover areas is required to be minimum 18 inch; however, it shows minimum 24" depth in detail 3 on sheet M3S-L5.02. Please clarify which depth shall be used for bidding purpose.

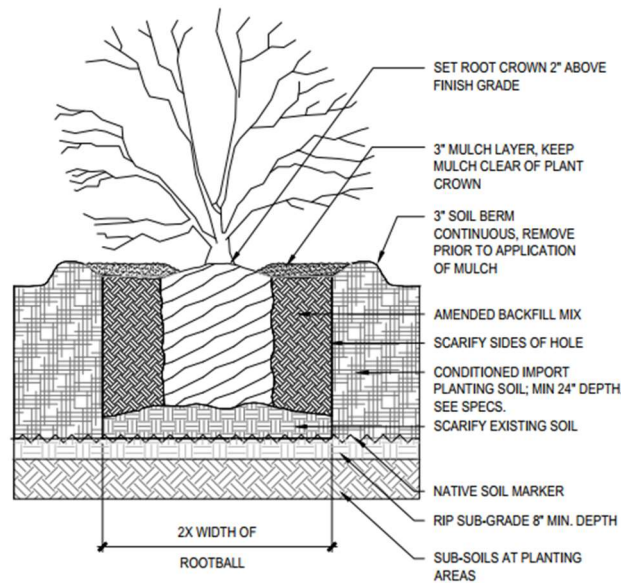

3

SHRUB PLANTING ON GRADE

SCALE: NTS

01-PLNT-SHRUB2

3.1 TOPSOIL PLACEMENT

- A. Notify Owner’s Agent and geotechnical engineering testing agency at least 48 hours prior to commencing any phase of topsoil placement.
- B. Refer to Drawings and details for the required horticultural soil depths at trees, shrubs, and understory planting areas.

*Special Provisions for Mission Bay Stormwater Pump Station 3
MBDG Project*

*Soil Preparation
July 01, 2024
02910-5*

- C. Ensure that all spoils from irrigation trenching or excavation deeper than 12 inches are placed a minimum of 12 inches below the finished grade or removed from the site.
- D. Place minimum 12 inches of topsoil over all lawn areas after rough grading.
- E. In shrub, ground cover and ornamental grass areas, place a minimum of 18-inches of topsoil over all planting areas after rough grading.
- F. Place first lift in a 3-inch layer. Incorporate to form a homogeneously blended layer 6 inches in depth.
- G. Place consecutive lifts in 6-inch layers, compacting each lift to 80 percent relative density. Provide lifts as required to reach finish grade.

A82: For all shrubs, please provide minimum 24" depth as shown in detail 3 on sheet M3S-L5.02.

Q83: Specification Section 2810 Irrigation System calls for a "Water Audit" however there are no WELO calculations associated with drawings. Confirm a water audit is required and if so provide the information the water audit is to confirm.

A83: A water audit is not required - please refer to Stormwater Pump Station 3 (M3S) Special Provisions Section 02810 for irrigation system requirements – See Bid Attachment 6.

Q84: Confirm if irrigation valve boxes are to be concrete per specification or plastic per details?

A84: Valve boxes shall be plastic per Stormwater Pump Station 3 (M3S) Special Provisions Section 02905-2.10 – See Bid Attachment 6.

Q85: Clarify irrigation main line installation depth, specifications call for 24" minimum cover while the irrigation legend notes 18".

A85: Please refer to trench depths indicated per Stormwater Pump Station 3 (M3S) Special Provisions Section 02905-3.4B – See Bid Attachment 6.

Q86: Clarify irrigation lateral line installation depth, specifications call for 18" minimum cover while the irrigation legend notes 12".

A86: Please refer to trench depths indicated per Stormwater Pump Station 3 (M3S) Special Provisions Section 02905-3.4B – See Bid Attachment 6.

Q87: The material schedule on sheet M3S-L0.02 and Detail 3/M3S-L4.02 call out a different bike rack than Spec. Sec. 02870 - 2.2 Site Furnishing. Please advise which bike rack is to be installed.

A87: Please refer to Stormwater Pump Station 3 (M3S) Special Provisions Section 02870-2.2B for bike rack specifications – See Bid Attachment 6.

– END OF INSTRUCTIONS TO BIDDERS –